

HSD1841 High Speed Drive

One complete HSD1841 High Speed Drive system consists of one DriTran epoxy composite nut, one TranTek Drive Screw and supports for each end. After considering all design criteria, use the ordering guide below to determine your standard part number. First, enter a three-digit *index length*, and then enter the letter that corresponds to your desired standard *mounting nut style*.

Typical Applications

Medium to heavy duty industrial processing
Horizontal and vertical axis material handling equipment
Automatic machine operation systems

Specifications:	
Major Diameter	1.875"
Minor Diameter	1.643"
Screw Lead	4.00"
Thread Starts	16
Thread Flank Angle	22.5°

Nut Length	6.5"
Load Surface Area	22.5in ²

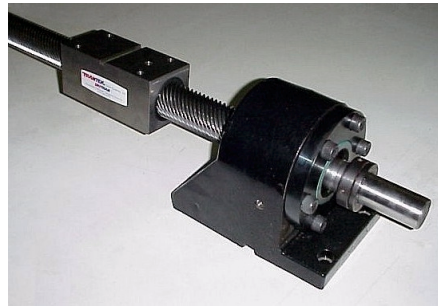

Optional Length Characteristics

Available Index *	Threaded Screw Length	Unsupported Screw Length	Total Screw Length	Critical R.P.M.	Critical Speed (ips)
36"	52.06"	53.31"	64.94"	4910	327
42"	58.06"	59.31"	70.94"	3967	264
48"	64.06"	65.31"	76.94"	3272	218
54"	70.06"	71.31"	82.94"	2744	183
60"	76.06"	77.31"	88.94"	2335	156
66"	82.06"	83.31"	94.94"	2011	134
72"	88.06"	89.31"	100.94"	1750	117
78"	94.06"	95.31"	106.94"	1536	102
84"	100.06"	101.31"	112.94"	1360	91
90"	106.06"	107.31"	118.94"	1212	81
96"	112.06"	113.31"	124.94"	1087	72
102"	118.06"	119.31"	130.94"	980	65
108"	124.06"	125.31"	136.94"	889	59

* Extra room is available for shocks, bumpers, hard stops, or other design considerations

Ordering Guide

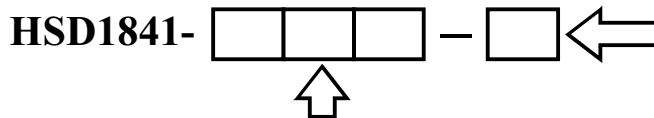

Enter a three-digit index length. For example, for a 36" index length enter "036". For available index lengths, see optional length characteristics table, above.

Mounting Nut Style

B = Block
F = Foot
R = Round

Refer to drawings on previous page.

HSD1841

Standard Layout (Base Nut Shown)

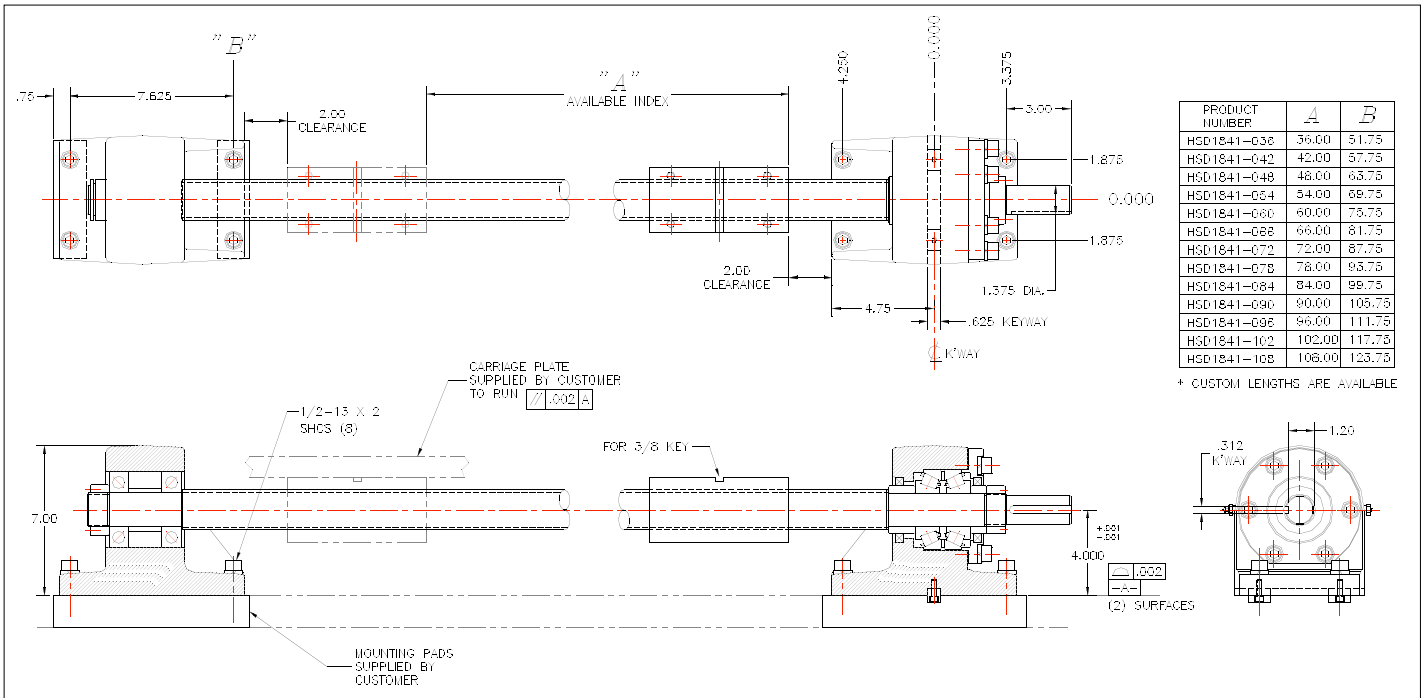

Base Nut

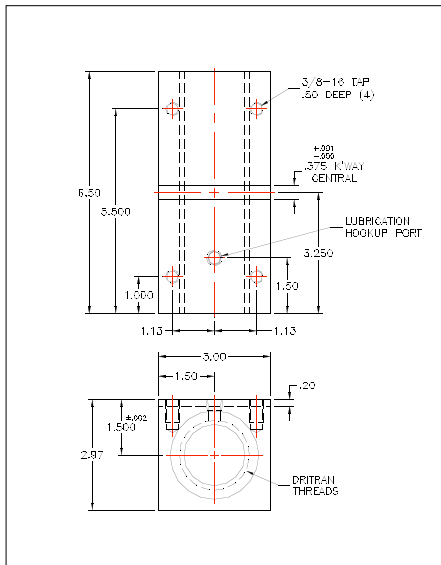

Foot Nut

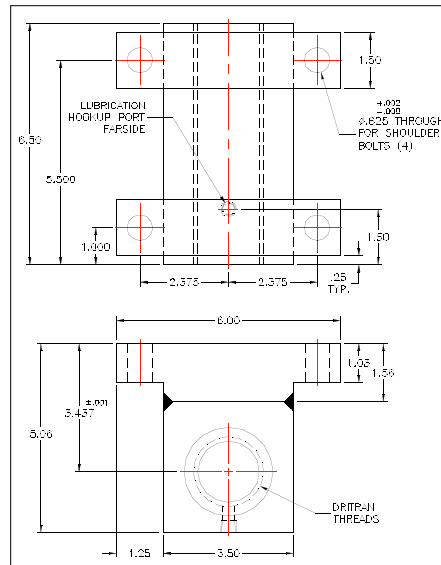

Round Nut

